

# Southwest Calgary Ring Road

## Traffic Advisory

July 25, 2018

---

### Traffic Realignment at Glenmore Trail and Sarcee Trail

**Location:** Intersection of Highway 8 / Sarcee Trail / Glenmore Trail S.W.

**Impact:** Realignment of traffic through a newly constructed intersection and closure of the existing intersection

**Reason:** Detour around construction activity for SWCRR bridges

**Implementation dates:**

- Saturday, July 28, 2018 – Realignment of southbound traffic on Sarcee Trail
- Friday, August 10, 2018 – Realignment of northbound traffic on Sarcee Trail

**Completion date:** Fall 2019

**Speed limit:** 60 km/h

**Other information:**

- Access will be maintained in all directions
- The new intersection will have similar traffic signal arrangements as the existing intersection
- The new intersection is designed to provide a comparable level of service
- For more information and maps, please visit [www.transportation.alberta.ca/swcrrdetour.htm](http://www.transportation.alberta.ca/swcrrdetour.htm)

For your safety, please obey all construction signs and when travelling through the area. KGL would like to thank you for your patience during this period of construction.



**SOUTHBOUND SARCEE TRAIL  
ROAD REALIGNMENT  
JULY 28, 2018**

RICHMOND ROAD

SARCEE TRAIL

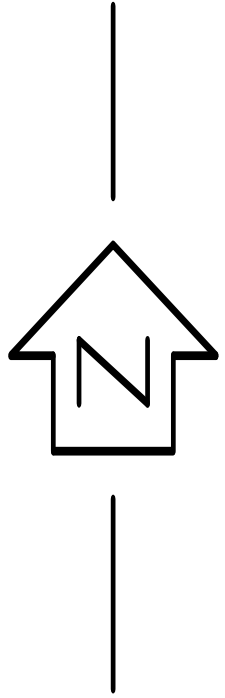

**EXISTING ROAD TO BE CLOSED**  
**NEW ROAD NOT YET OPEN**

HIGHWAY 8

GLENMORE TRAIL

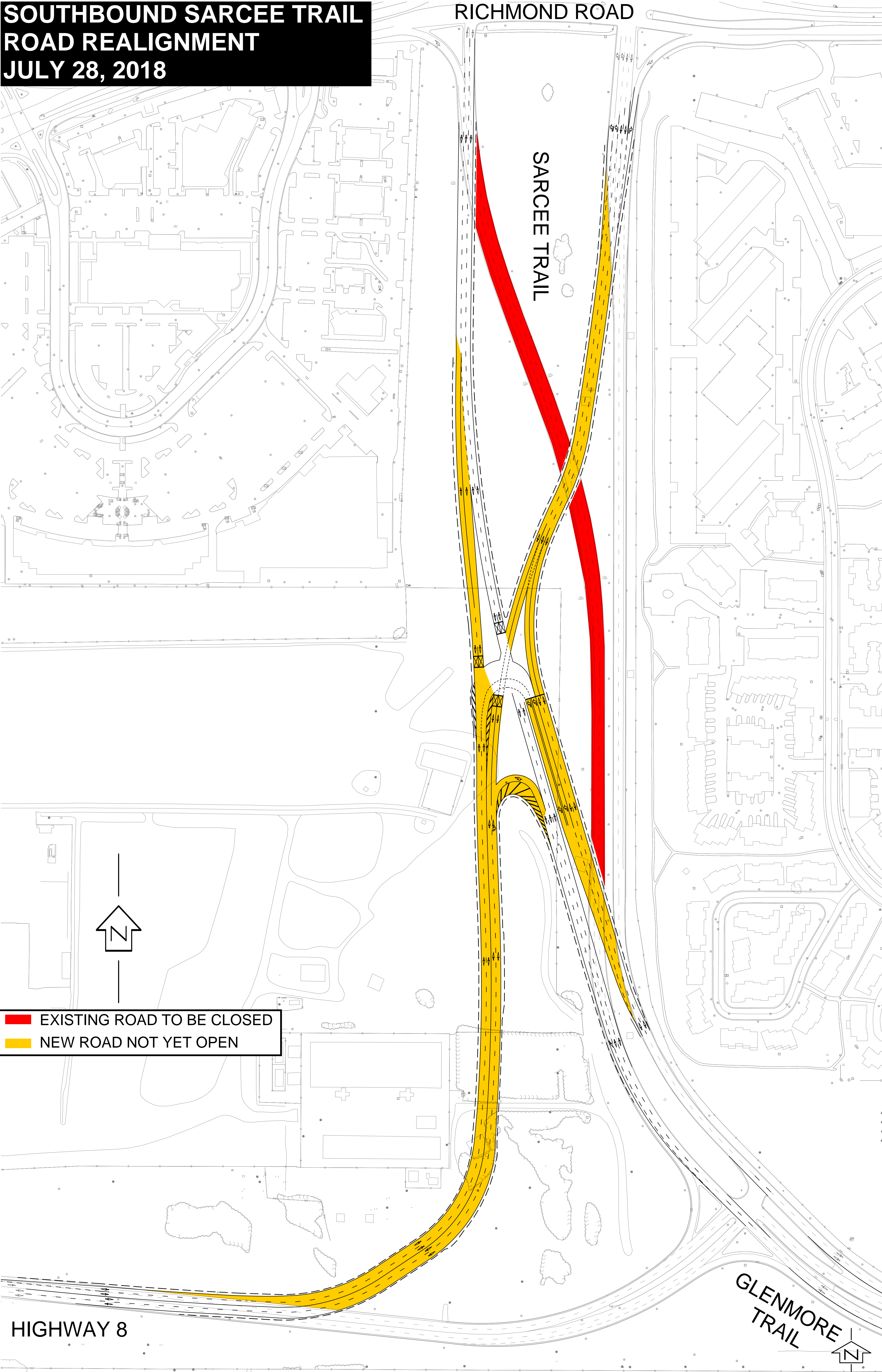
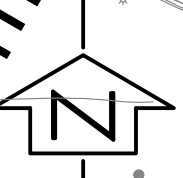



**NORTHBOUND SARCEE TRAIL  
ROAD REALIGNMENT  
AUGUST 10, 2018**

RICHMOND ROAD

SARCEE TRAIL

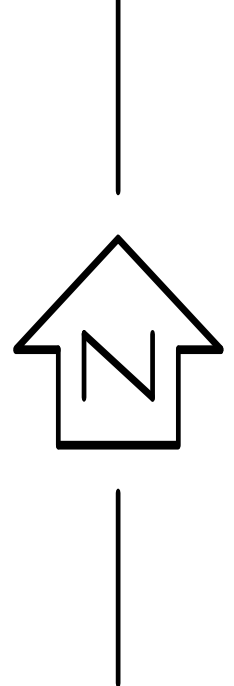

 EXISTING ROAD TO BE CLOSED

HIGHWAY 8

GLENMORE TRAIL

